

walton

STUDIO

Bermudez / Price

PART 1 PRECEDENTS STUDY (Job 1)

STARTS Monday 28 August
DUE Friday 8 September at 2:15PM

GENERAL GOAL These first two weeks are intended to provide you with the basic *historical, programmatic, phenomenological, and conceptual scaffolding* for the rest of the semester. It involves analyzing pre-modern and modern Catholic Churches as well as getting familiar with the programmatic, liturgical, metaphoric, and experiential dimensions of Catholic sacred spaces.

TEAMWORK The Walton Studio asks you to work in teams of 2-3 individuals.

JOB 1 **Architectural Study.** Select 2 Catholic Churches from each historical period below and proceed to analyze them:
Traditional period: Byzantine, Romanesque, Gothic, Renaissance, Baroque, Rococo, Neoclassical, Neogothic, Eclectic
Modern period: Time Frame from Sagrada Familia by Antoni Gaudi (1852–1926) to 2023.

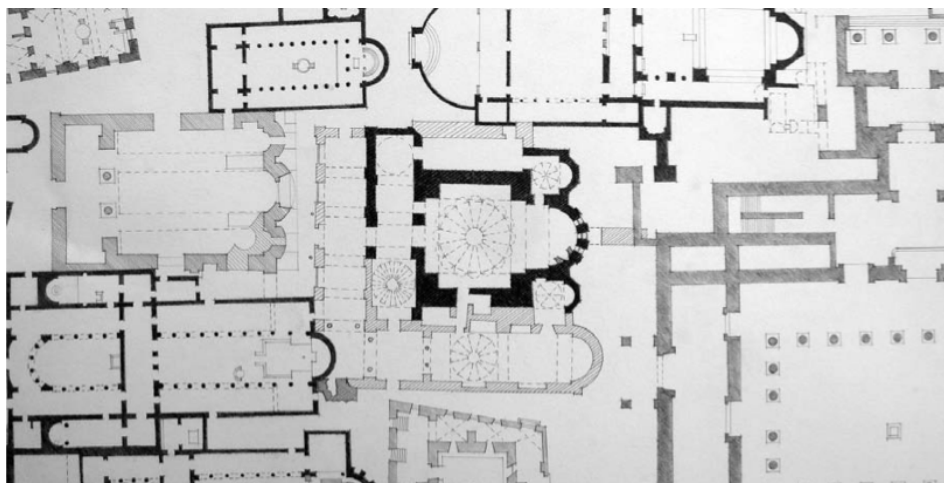

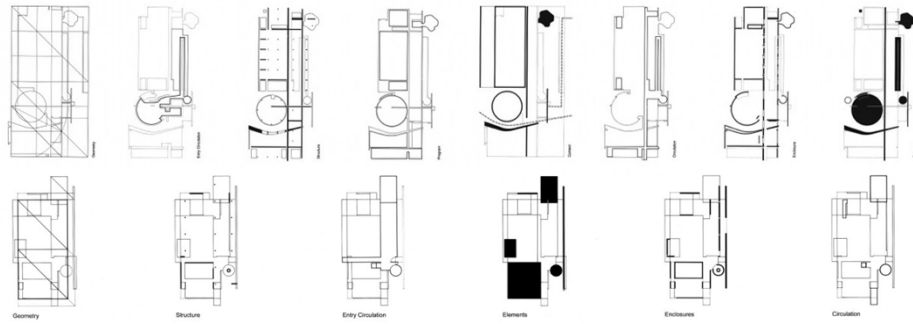

You are to analyze the following architectural properties in each case study:

- Spatial configuration and order (form, geometry, composition, scale, etc.)
- Programmatic organization (functions—served and serving)
- Liturgy
- Context (within a building, city, or nature)
- Tectonics (Light and Materiality)
- Phenomenology (i.e., experience)
- Symbolism & Art Integration
- METAPHOR

Please consider the best way in which you could summarize/register your study. The use of a Matrix is likely to be very helpful. We recommend utilizing annotated/abstracted diagrams (freehand overlays, etc.) of your precedents' plans, sections, facades, axons, and/or perspective/photos to compare and contrast them to draw communicable/usable insights.

REFERENCES

Clark, Roger H. *“Precedents in Architecture: Analytic Diagrams, Formative ideas and Partis.”* NA2750.C55 (several editions available in Architecture Library)

For examples refer to: <http://juliobermudez.com/courses/202/other.htm>

For digital resources refer to: <https://juliobermudez.com/courses/636/digital-resources.htm>

walton

STUDIO

Bermudez / Price

PART 1 PRECEDENTS STUDY (Jobs 2 & 3)

STARTS Monday 28 August
DUE Friday 8 September at 2:15PM



JOB 2 Liturgical/Symbolic Study. Using readings, lectures, visitation, experience, and discussions, please summarize a Catholic Church's key functions and requirements. Part of this job will include (1) participating in a Church visit guided by a Catholic Priest, (2) reading the material cited below, and (3) attending Mass and visiting a Catholic Church at least once within the next two weeks.

Once again, consider the best way in which your understanding can be communicated to a reviewing body.

JOB 3 Begin devising **METAPHORS** from these two investigations (Job 1 & 2).

Your references will be:

For **Catholic Liturgy**, the General Instruction of the Roman Missal:

<http://www.usccb.org/prayer-and-worship/the-mass/general-instruction-of-the-roman-missal/>

For **experiencing** the liturgy and examples of chapels:

You are expected to attend mass at and visit a church within the next two weeks. This may not need to happen on campus, but there are plenty of opportunities to do it here. As of our last count, there are four active chapels on campus: *St. Michael Chapel* (in Maloney Hall), *St. Vincent de Paul Chapel* (on John McCormack Road, between Millennium North and Millennium South Residence Halls), *Mary, Mirror of Justice Chapel* (in the Columbus School of Law). In addition, of course, there is the upper Church and the Crypt Church of Basilica of the Immaculate Conception that you are also invited to visit. It goes without saying that the *Caldwell Chapel* (in Caldwell Hall) is beautiful and deserves a visit. For more info go to:

<https://ministry.catholic.edu/worship/sacred%20spaces%20on%20campus/index.html>
<https://www.nationalshrine.org/interactive-map/>

what is really important here is to become as aware as possible of all the experiential dimensions of the sacred experience during mass, visit, and prayer/contemplation. This includes all your senses but also emotions, intuitions, symbolism, and thinking. Make appropriate notes NOT during your experience but afterward.

For **Catholic church architecture**:

The Church. Unlocking the Secrets of the Places Catholics Call Home, by Cardinal Donald Wuerl and Mike Aquilina (New York: Random House, 2013)

Built of Living Stones: Art, Architecture, and Worship, U.S. Conference of Catholic Bishops (2000). URL: <https://nyliturgy.org/wp-content/uploads/BOLS.pdf>

GRADE Part 1 counts for 12.5 % of the course grade